

Depth to ground water, Burmester quadrangle, Tooele County, Utah.

COMPILED BY BILL D. BLACK
DRAFTED BY NOAH P. SNYDER

Utah Geological Survey
Open-File Report 318 PLATE 4C
1995

BURMESTER QUADRANGLE
UTAH—TOOELE CO.
7.5 MINUTE SERIES ORTHOPHOTOMAP (TOPOGRAPHIC)

UNITED STATES
DEPARTMENT OF THE INTERIOR
GEOLOGICAL SURVEY

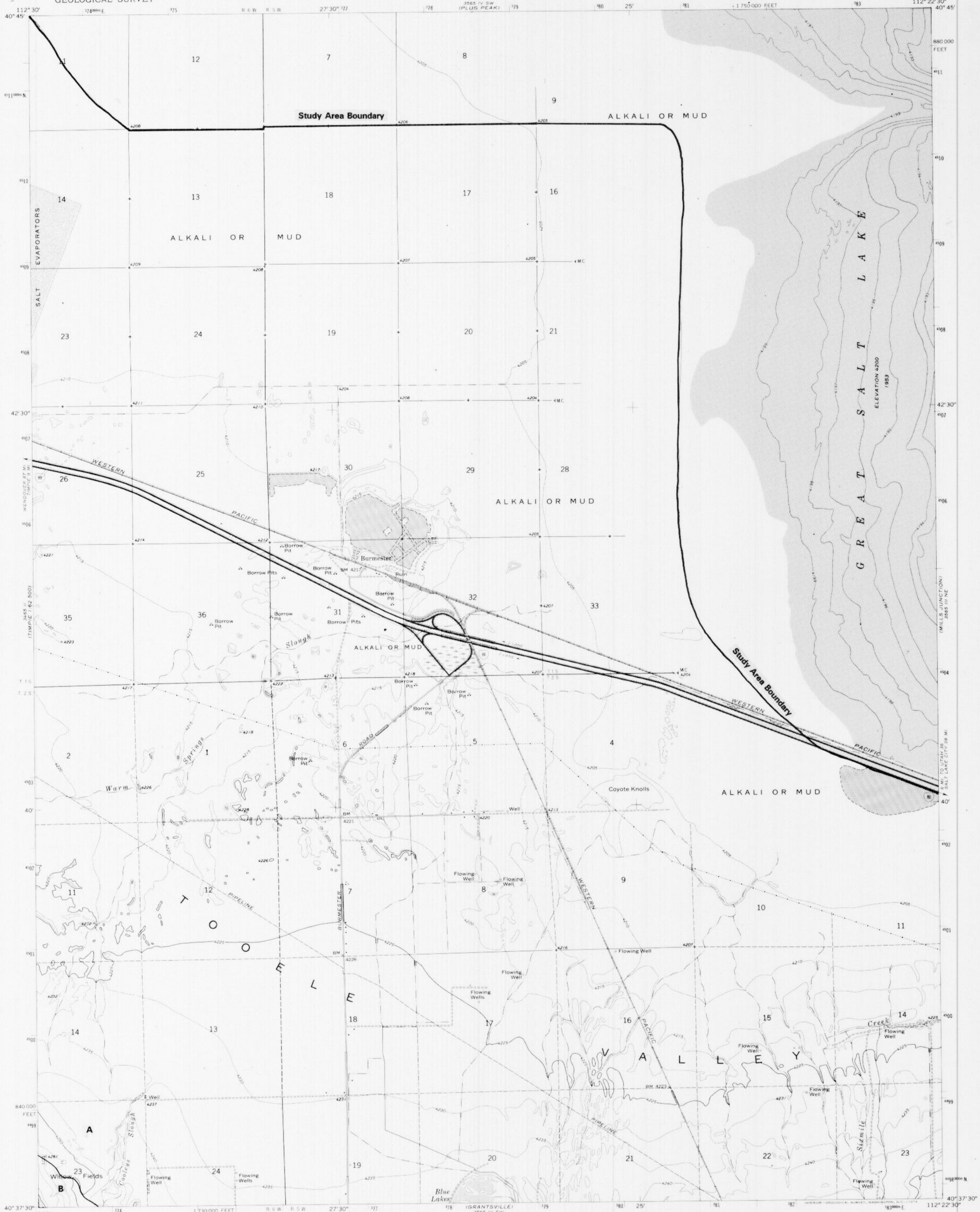

Mapped, edited, and published by the Geological Survey

Control by USGS and USC&GS

Planimetry by photogrammetric methods from aerial photographs taken 1963. Topography by plane-table surveys 1923 and 1955. Revision and orthophotosac from aerial photographs taken 1971. Field checked 1972.

Underwater contours by photogrammetric methods from aerial photographs taken 1966, 1969, and 1971-72.

Projection and 10,000-foot grid ticks: Utah coordinate system, central zone (Lambert conformal conic). 1000-meter Universal Transverse Mercator grid ticks, zone 12, shown in blue. 1927 North American datum.

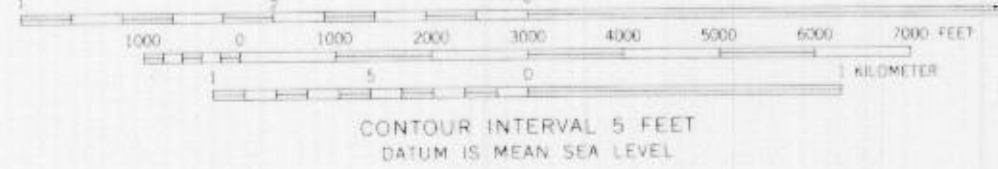

CONTOUR INTERVAL 5 FEET
DATUM IS MEAN SEA LEVEL

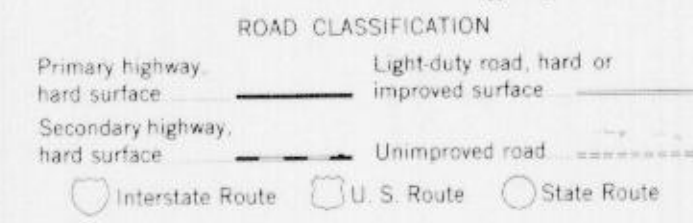

BURMESTER, UTAH

N4037.5—W11222.5/7.5

1972

AMS 3560 III NW—SERIES V8970

EXPLANATION

Depth to ground water

- A*** Less than 10 feet (3 m).
- B** 10 to 30 feet (3-9 m).
- C** 30 to 50 feet (9-15 m).
- D** Greater than 50 feet (15 m).

* Special studies are recommended in areas where the depth to ground water is less than 10 feet (3 m) (see table 1).

